

## PRODUCT DATA SHEET

---

Part number 216309

---

EAN 4015609012787

Manufacturer WALTHER-WERKE

WEEE-Reg.-Nr: DE 22131895

### Product description

---

MONDO Angled Plug 16A 3P 9h with back part in light grey

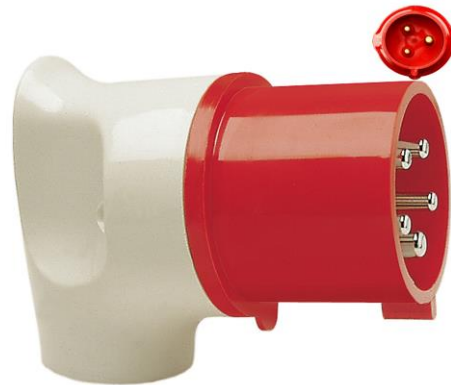

Product Image

### Detailed product description

---

WALTHER Angled plug 16A 3P 400V 9h IP44  
 from the MONDO series  
 made from PA6 material  
 with screw terminal  
 back part in light grey (RAL 7035)

### Ordering information

---





order unit	Piece
customs number	85366990
net weight	0.106 kg
packing quantity (VPE)	10
length of the packaging	0.31 m
width of the packaging	0.163 m
depth of the packaging	0.113 m
gross weight(VPE)	1.172 kg

### Conformities

---

CE conformity	v
RoHS directive	2011/65/EU
RoHS directive	2015/863/EU
REACH regulation	1907/2006

## Certification

VDE/ENEC certification	40024787	
UL certification	No. E329476	
UL certification	No. E188992	
EAC certification	BY112.02.01.020 06090	

## Classification system

classification system	ETIM_7.0
ETIM Class	EC000140

## Technical product data

IEC-amperage	16 A
Amperage according to UL/CSA (for UL-version)	20 A
Number of poles	3
Voltage according to EN 60309-2	400 V (50+60 Hz) red
Clock hour position	9 h
Identification colour	Red
Conductor cross-section	1 - 2.5 mm <sup>2</sup>
Cable diameter	8 - 15 mm
Cable strip length	30 mm +/- 2 mm
Cable ferrules length	10 mm +/- 1 mm
Maximum torque terminal screw	0.8 Nm
Maximum torque cable gland	4 Nm
RAL-number	7035
Degree of protection (IP)	IP44
Connection system	Screwed terminal
Contact material	Brass standard
Cable entry	Anti-kink sleeve
Angle of plug	Right-angled
Material	Plastic
Inflammability class of insulation material according to with UL94	V2

## Dimension sheet

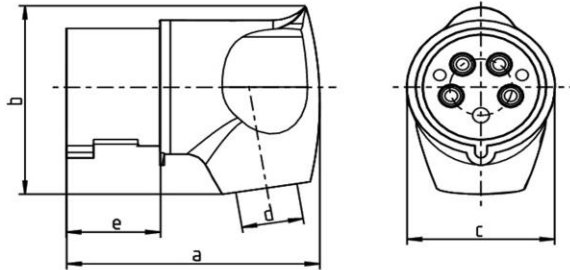

Amp.	16			32		
	3	4	5	3	4	5
a	85	98	98	115	115	115
b	70	86	86	96	96	100
c	50,3	64,3	64,3	72	72	72
d	8/15	10/16,5	10/16,5	11/22	11/22	11/22
e	37	37	37	45,8	45,8	45,8