

## PRODUCT DATA SHEET

---

Part number 216404

---

EAN 4015609012848

Manufacturer WALTHER-WERKE

WEEE-Reg.-Number: DE 22131895

---

### Product description

---

MONDO angled plug 16A 4P 4h with back part in light grey



Similar image

### Detailed product description

---

WALTHER angled Plug 16A 4P 110V 4h IP44  
 from MONDO series  
 made from PA6 material  
 with screw terminal  
 back part in light grey (RAL 7035)

### Ordering Information

---





Order unit	Piece
Customs number	85366990
Net weight	0,15 kg
Packing quantity (VPE)	10
Length of the packaging	0,31 m
Width of the packaging	0,163 m
Depth of the packaging	0,113 m
Gross weight(VPE)	1,612 kg

### Certificates

---

VDE/ENEC certification 40024787



UL certification	No. E329476	
UL certification	No. E188992	
EAC certification	BY112.02.01.020 06090	
CSA certification	70096522	

## Classification system

---

Classification system	ETIM_6.0
ETIM Class	EC000140

## Technical product data

---

IEC-amperage	16 A
Amperage acc. UL/CSA (for UL-version)	20 A
Number of poles	4
Voltage acc. EN 60309-2	110 V (50+60 Hz) yellow
Clock hour position	4 h
Identification colour	Yellow
RAL-number	1018
Degree of protection (IP)	IP44
Connection system	Screwed terminal
Cable entry	Anti-kink sleeve
Angle of plug	Angled
Material	Plastic

## Dimension sheet

---

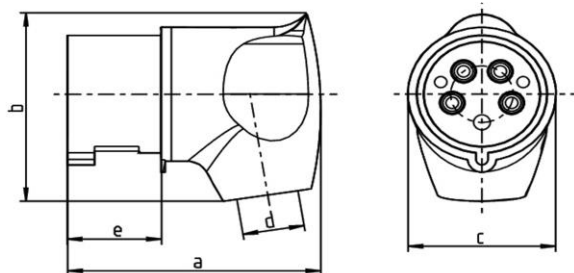

Amp.	16			32		
Pole	3	4	5	3	4	5
a	85	98	98	115	115	115
b	70	86	86	96	96	100
c	50,3	64,3	64,3	72	72	72
d	8/15	10/16,5	10/16,5	11/22	11/22	11/22
e	37	37	37	45,8	45,8	45,8