

## PRODUCT DATA SHEET

---

Part number 236406PW

EAN 4015609170159

Manufacturer WALTHER-WERKE

WEEE-Reg.-Nr: DE 22131895

### Product description

---

MONDO Angled Plug 32A 4P 6h with back part in pearl white



Product Image

### Detailed product description

---

WALTHER Angled plug 32A 4P 400V 6h IP44  
 from the MONDO series  
 made from PA6 material  
 with screw terminal  
 back part in pearl white (RAL 1013)

### Ordering information

---



|                         |          |
|-------------------------|----------|
| order unit              | Piece    |
| customs number          | 85366990 |
| net weight              | 0.23 kg  |
| packing quantity (VPE)  | 10       |
| length of the packaging | 0.31 m   |
| width of the packaging  | 0.255 m  |
| depth of the packaging  | 0.15 m   |
| gross weight(VPE)       | 2.496 kg |

### Conformities

---

|                  |             |
|------------------|-------------|
| CE conformity    | √           |
| RoHS directive   | 2011/65/EU  |
| RoHS directive   | 2015/863/EU |
| REACH regulation | 1907/2006   |

## Certification

|                        |                       |   |
|------------------------|-----------------------|---|
| VDE/ENEC certification | 40021520              |  |
| EAC certification      | BY112.02.01.020 06090 |  |

## Classification system

|                       |          |
|-----------------------|----------|
| classification system | ETIM_7.0 |
| ETIM Class            | EC000140 |

## Technical product data

|  |                         |
|--|-------------------------|
| IEC-amperage   | 32 A                    |
| Number of poles  | 4                       |
| Voltage according to EN 60309-2                                    | 400 V (50+60 Hz) red    |
| Clock hour position  | 6 h                     |
| Identification colour  | Red                     |
| Conductor cross-section  | 2.5 - 6 mm <sup>2</sup> |
| Cable diameter   | 11 - 22 mm              |
| Cable strip length   | 45 mm +/- 2.5 mm        |
| Cable ferrules length  | 10 mm +/- 1 mm          |
| Maximum torque terminal screw                                      | 0.8 Nm                  |
| Maximum torque cable gland   | 4 Nm                    |
| RAL-number   | 1013                    |
| Degree of protection (IP)  | IP44                    |
| Connection system  | Screwed terminal        |
| Contact material   | Brass standard          |
| Cable entry  | Swivel                  |
| Angle of plug  | Right-angled            |
| Material   | Plastic                 |
| Inflammability class of insulation material according to with UL94 | V2                      |

## Dimension sheet

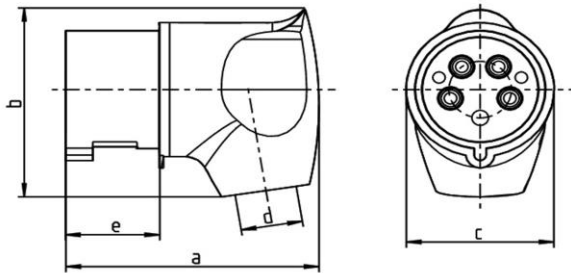

| Amp. | 16   |         |         | 32    |       |       |
|------|------|---------|---------|-------|-------|-------|
|      | 3    | 4       | 5       | 3     | 4     | 5     |
| a    | 85   | 98      | 98      | 115   | 115   | 115   |
| b    | 70   | 86      | 86      | 96    | 96    | 100   |
| c    | 50,3 | 64,3    | 64,3    | 72    | 72    | 72    |
| d    | 8/15 | 10/16,5 | 10/16,5 | 11/22 | 11/22 | 11/22 |
| e    | 37   | 37      | 37      | 45,8  | 45,8  | 45,8  |